



Mech-Eye PRO L

DATASHEET



Mech-Eye PRO L



With a **working distance of 1,200 mm - 3,500 mm** and a **calibration accuracy of 3.0 mm**, the PRO L camera is especially suitable in scenarios that require a large field of view.

Specifications

The PRO L is ideally suited for applications such as palletizing & depalletizing of Euro pallets as well as parts removal from wire mesh boxes.

Scope of delivery

PRO L Camera

Power - M12, 4-pin, A-coded to EU 230 (10 m) *

Data - M12, 8-pin, A-coded to RJ45 (10 m) *

*further cable lengths are available

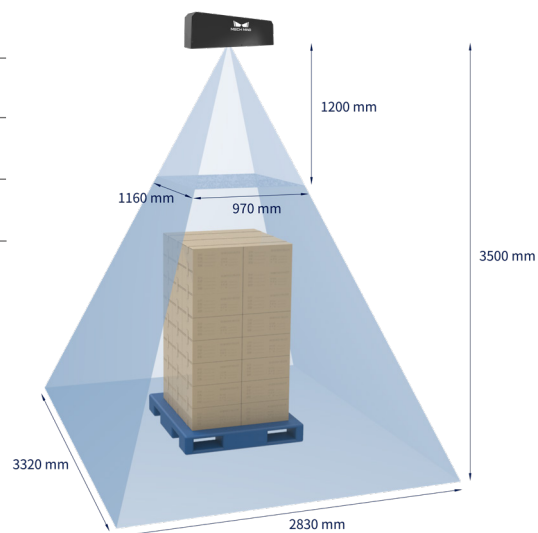

Technical drawing

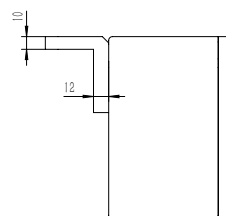
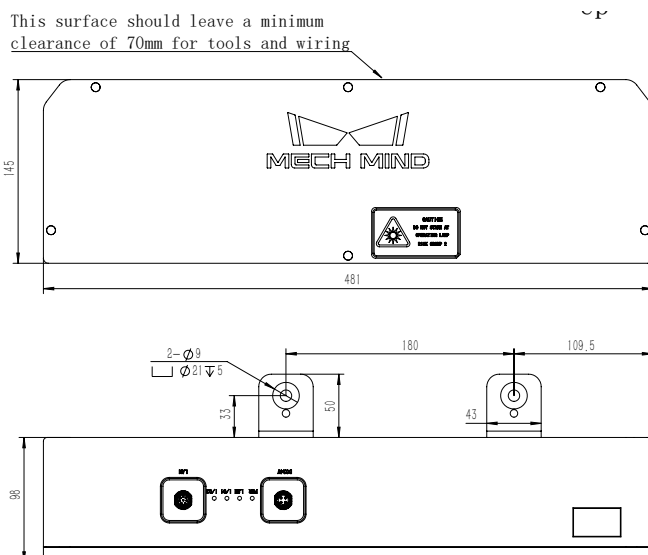

Technical data

Optimal scanning range	1,200 - 3,500 mm
Min. FOV	970 x 1,160 mm @ 1.2 m
Max. FOV	2,830 x 3,320 mm @ 3.5 m
Resolution	2,048 x 1,536 px (3.0 MP)
Sensor type	CMOS (RGB)
Projector	structured light (LED)
Z Repeatability	1 mm @ 3 m
Calibration accuracy	3 mm @ 3 m
Typical capture time	0.7 - 1.1 s
Baseline	400 mm
Dimension	481 x 98 x 145 mm
Weight	4.3 kg
Working temperature	0 - 45 °C (max. gradient 10°/hour)
Interface	GigE, C++, C#, Python, ROS
Connectors	M12, 8-pin, A-coded (F) - Data M12, 4-pin, A-coded (F) - Power
Power supply	24V DC / 3.75A
Certification	CE/FCC/VCCI
Protection class	IP65
Cooling	Passive



 www.mech-mind.de

 info@mech-mind.de