



Mech-Eye LOG S

DATASHEET



Mech-Eye LOG S



With a **working distance of 500 mm - 1,000 mm** and a **calibration accuracy of 0.2 mm**, the LOG S camera covers a wide range of industrial applications where shorter ranges are sufficient.

Specifications

The LOG S is ideal for applications such as bin picking, sorting & picking, and locating small components.

Scope of delivery

LOG S Camera

Power - M12, 4-pin, A-coded to EU 230 (10 m) *

Data - M12, 8-pin, A-coded to RJ45 (10 m) *

*further cable lengths are available

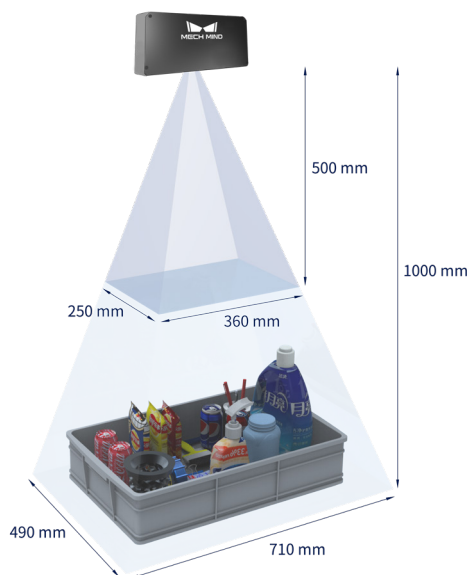

Technical drawing

This surface should leave a minimum clearance of 70mm for tools and wiring.

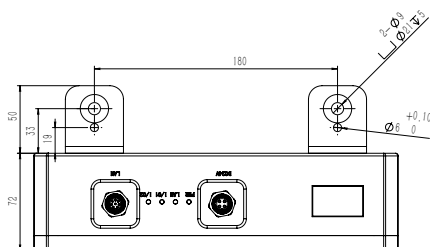
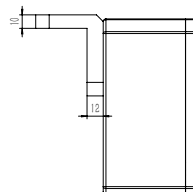
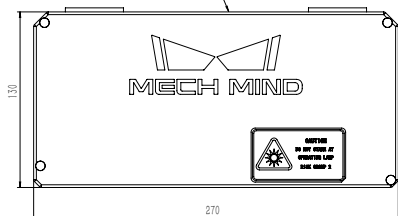

Technical data

Optimal scanning range	500 - 1,000 mm
Min. FOV	360 x 250 mm @ 0.5 m
Max. FOV	710 x 490 mm @ 1 m
Resolution	1,280 x 1,024 px (1.3 MP)
Sensor type	CMOS (RGB)
Projector	structured light (LED)
Z Repeatability	0.1 mm @ 1 m
Calibration accuracy	0.2 mm @ 1 m
Typical capture time	0.3 - 0.5 s
Baseline	150 mm
Dimension	270 x 72 x 130 mm
Weight	2.2 kg
Working temperature	0 - 45 °C (max. gradient 10°/hour)
Interface	GigE, C++, C#, Python, ROS
Connectors	M12, 8-pin, A-coded (F) - Data M12, 4-pin, A-coded (F) - Power
Power supply	24V DC / 3.75A
Certification	CE/FCC/VCCI
Protection class	IP65
Cooling	Passive



 www.mech-mind.de

 info@mech-mind.de